



BUFFALO
GROVE
PARK
DISTRICT

To: Tracey Crawford, NWSRA Executive Director
NWSRA Board of Directors
From: Ryan Risinger, Buffalo Grove Park District
RE: ADA Compliance Projects
Date: February 16, 2018

The Buffalo Grove Park District respectfully requests approval from the NWSRA Board of Directors that the following expenditures of \$403,685.25 be paid from the Park District's Special Recreation Levy. The improvements listed will provide direct benefits to the partnership that the Park District has with NWSRA and the participants that are served through our Joint Agreement. Details of all expenses follow these summaries.

ADA Surface Work: The Park District had renovation projects at three different parks that included ADA compliant surface work. They included bike path renovations at Willow Stream Park, Alcott, and Longfellow Park. The ADA specific work cost for each site is as follows. Willow Stream Park bike path renovation, 5' of an 8' path at \$2,554, bike path renovation Longfellow Park, 5' of 8' path at \$8,494.25, and sidewalk path renovation at Alcott 5' of 5' path at \$10,524. Additional material including a detail of costs is attached.

Description	Cost	ADA %	Reimbursement
ADA Surface Work	\$21,572.25	100%	\$21,572.25

Green Lake Park Fishing Deck Design: The Park District has paid for the consulting costs of an upcoming project that includes an ADA accessible fishing pier. The Landscape Architect Upland Design, has indicated that 20% of the deck engineering fees is the typical costs they attribute to ADA.

Description	Cost	ADA %	Reimbursement
Fishing Deck Design (detail attached)	\$8,422	20%	\$1,684

CAC Interior Renovation: The Park District asked Legat Architects to detail out the ADA accessible compliant components for the Community Arts Center renovation project. The total renovation cost of the project is \$2,655,000. Based on the attached detailed list the ADA component costs and A/E fees total \$297,000.

Description	Cost	ADA %	Reimbursement
CAC Renovation ADA(detail attached)	\$297,000	100%	\$297,000

Playground Surface Replenishment: We are requesting reimbursement for Engineered Fiber safety surface replenishment for following parks, Mill Creek, Old Farm, Parkchester, Prairie Grove, Veterans, Apple Hill, Mirielle, Rolling Hills, and Willow Stream. The total cost is \$19,929.00.

Description	Cost	ADA %	Reimbursement
Surface replenishment (Detail attached)	\$2,640	100%	\$19,929

Poured in Place Rubber Surface: We are requesting reimbursement for poured in place rubber surfacing installed at Cherbourg Park Playground. The cost for 5,610 sq. ft. playground was \$63,500. Attached you will find a copy of the invoice from NuToys.

Description	Cost	ADA %	Reimbursement
Poured in Place Surface	\$63,500	100%	\$63,500

Summary: In summary, we are requesting \$403,685.25 for the following ADA projects:

ADA Surface Work	\$21,572.25
Green Lake Park Fishing Deck Design	\$1,684
CAC Interior Renovation	\$297,000
Playground Surface Replenishment	\$19,929
Poured in Place Rubber Surface	\$63,500
Total	\$403,685.25

Thank you for your consideration. Should there be any additional material needed, please let me know.

Respectfully,



Ryan Risinger
Executive Director

Client: Buffalo Grove Park District
Project: 2017 Site Improvements
GHA Project No: 4647.211
Project Manager: Tom Rychlik

ADA Cost Breakdown

Item No.	Longfellow Park ADA	Qty	Unit	Chicagoland Paving	
	Description			Unit Price	Total
1	HMA path removal - Surface Only, stone to remain	112.5	SY	\$10.00	\$1,125.00
2	PCC Sidewalk Installation	917	SF	\$7.75	\$7,106.75
3	Aggregate Base Course - CA-6 - 1" & Varies	105	SY	\$2.50	\$262.50
Total ADA Cost					\$8,494.25

Willow Stream Tennis Courts

1	Removal of Fence Fabric, Rails and Gates	450	LF	\$5.00	\$2,250.00
2	Removal of Tennis Net Foundations	4	EA	\$350.00	\$1,400.00
3	Light pole removal	4	EA	\$100.00	\$400.00
4	1/2" DIA. Holes Drilled into Existing Surface	500	EA	\$5.00	\$2,500.00
5	4" Perforated PVC Underdrain	400	LF	\$34.75	\$13,900.00
6	4" Cleanout	1	EA	\$540.00	\$540.00
7	HMA Binder Course (2")	160	TN	\$87.50	\$14,000.00
8	HMA Surface Course, (2")	160	TN	\$100.00	\$16,000.00
9	Aggregate Base Course - 6" CA-6	1385	SY	\$8.50	\$11,772.50
10	Aggregate Base Course - 6" CA-7	1385	SY	\$10.00	\$13,850.00
11	12" Ribbon Curb	460	LF	\$25.00	\$11,500.00
12	Tennis Net Foundation Installation	4	EA	\$1,000.00	\$4,000.00
13	Light Pole Installation	1	LS	\$28,900.00	\$28,900.00
14	9' Fence Fabric and Rail Installation	460	LF	\$15.00	\$6,900.00
15	8' Screen (Collegiate Pacific Sports)	460	LF	\$7.50	\$3,450.00
16	6' Gate Modification / Installation	1	EA	\$1,000.00	\$1,000.00
17	Court Color Coat (Tennis, Pickleball, And Basketball)	1385	SY	\$10.55	\$14,611.75
18	Tennis Net Center Tie Down	2	EA	\$350.00	\$700.00
19	Insert-A-Tee Connection	1	EA	\$900.00	\$900.00
Total Tennis Cost					\$148,574.25

Willow Stream ADA

1	HMA Surface Removal, Cold Milling 2"	84	SY	\$10.00	\$840.00
2	HMA Surface Course, (2")	10	TN	\$100.00	\$1,000.00
3	Aggregate Base Course - 6" CA-6	84	SY	\$8.50	\$714.00
Total ADA Cost					\$2,554.00

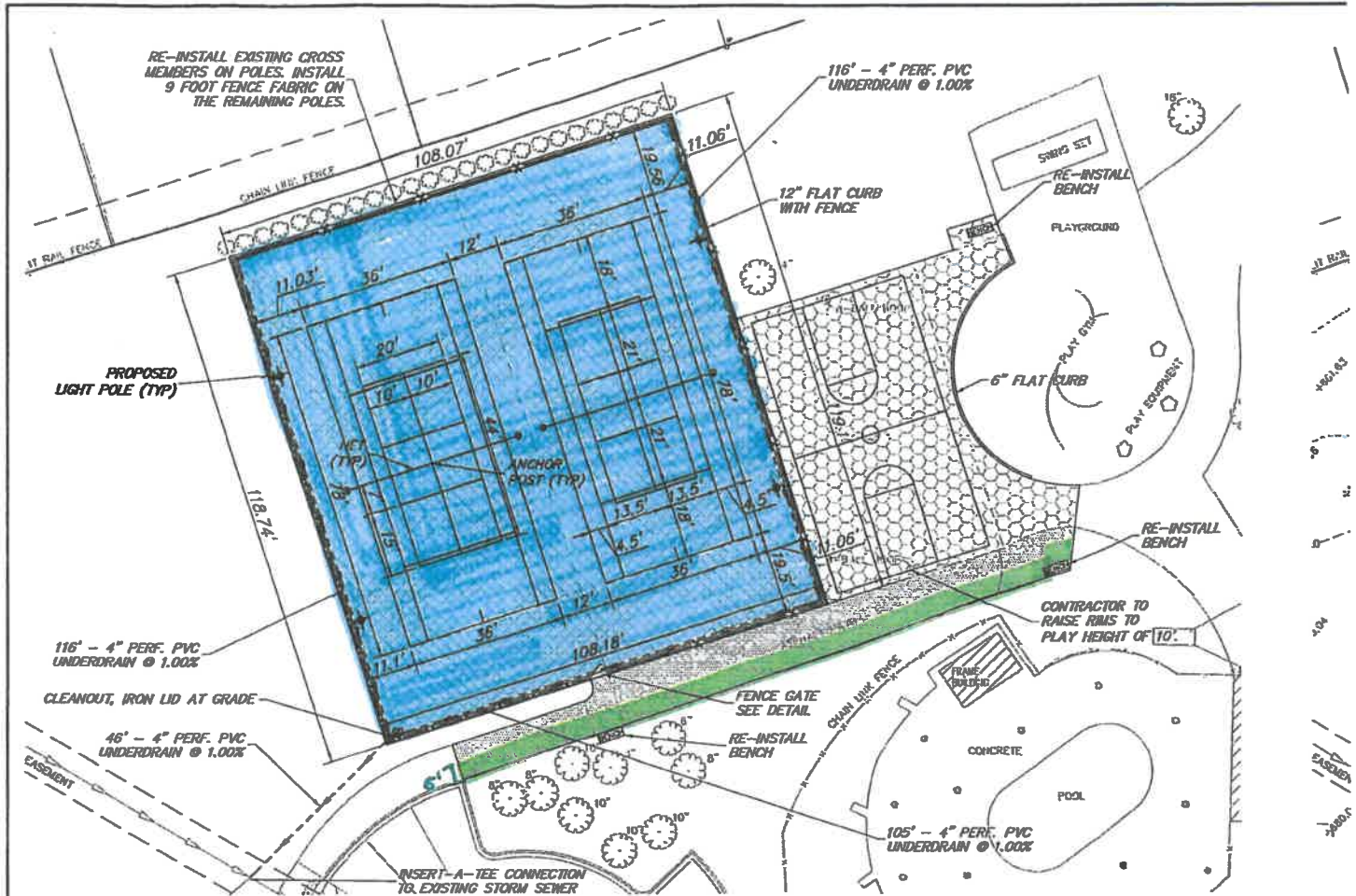

GEOMETRIC AND UTILITY PLAN

GEOMETRIC AND PAVING PLAN

1. All pavement dimensions are to edge of pavement, unless otherwise noted. E=edge of pavement, B=back of curb, F=face of curb. Radii dimensions are to back of curb.
2. Provide 1.90% cross slope and 4.5% maximum longitudinal slope on all sidewalks and pedestrian path ways unless otherwise indicated. Illinois accessibility code requires a maximum constructed cross slope of 2.00% and longitudinal slope of 5.00%.
3. Install bituminous pavement as shown. Refer to detail sheet for specific pavement sections and general note sheet for construction, testing and compaction requirements.
4. Contractor shall install temporary erosion control seed and blanket as necessary to meet soil erosion and sediment control requirements. Refer to notes and details throughout the plan set for specific material requirements.
5. For final restoration, the contractor shall be responsible for restoring all disturbed turf areas and proposed turf areas as follows:
 - a. Prior to placement of topsoil restoration area subgrade material shall be rototilled and re-compacted to a maximum of 80% standard proctor to a depth of 6\".
 - b. Spread a minimum of 6\" of existing site salvaged screened topsoil or new pulverized topsoil on all disturbed areas.
 - c. Topsoil must be free of litter, brush, rocks and earth clods of greater than 1 inch in any dimension. Contain between 1%-10% organic matter, 12%-50% clay, and less than 55% sand content. pH shall be between 6.0 and 8.0.
 - d. Seed restoration areas as follows:
 - i. IDOT Class 1 seed. (Lawn mixture)
 - ii. Fertilizer shall be applied following IDOT requirements.
 - iii. Erosion control blanket shall be North American Green S75 or approved equal installed following manufacturer guidelines.
6. Once restoration has been completed, the contractor shall remove erosion control devices. Silt fence trenches shall be backfilled and restored in kind. Storm structures shall be cleaned of debris.
7. Install All 12\" flat curb around perimeter of tennis court, contraction joints shall be tooled at each pole.
8. Install new 9 foot high chain link fence as shown. Fence fabric and diameters to match existing. Top and bottom rail for 9 foot high fence is required.
9. Hot mix Asphalt (HMA) paving - After passing proof roll, the contractor shall string line the tennis and basketball courts and perform flooding and nickel test (see specifications for details). Any areas that do not meet minimum pavement cross slope (1.0%) will be corrected, re-compacted and re-proof rolled.

PROPOSED LEGEND

	HMA SURFACE COURSE, SEE DETAIL
	HMA PAVEMENT, SEE DETAIL
	SIP SHEET, SEE SECTION
	12" FLAT CURB WITH FENCE
	6" FLAT CURB
	PROPOSED TENNIS NET POST
	PROPOSED LIGHT POLE
	PROPOSED UNDERDRAIN

PAVEMENT COLORS

1. Owner to approve color scheme pattern during shop drawing review.
2. General colors of the pavement and pavement marking are as follows:
 - a. The inside of the tennis court will be blue.
 - b. The outside of the tennis court will be green.
 - c. The tennis court lines will be white.
 - d. The pickleball lines will be red. The tennis court lines take precedence over the pickleball lines.
 - e. The basketball court to the grade breaks will be red.
 - f. The basketball lines will be white.

WILLOW STREAM

GEOMETRIC/GRADIN

**WILLOW STREAM & LONGFELLOW PA
BUFFALO GROVE PARK DI
VILLAGE OF BUFFALO GROVE**

GHA GEWALT HAMILTON ASSOCIATES, INC.

625 Forest Edge Drive ▪ Vernon Hills, IL 60061
TEL 847.478.9700 ▪ FAX 847.478.9701





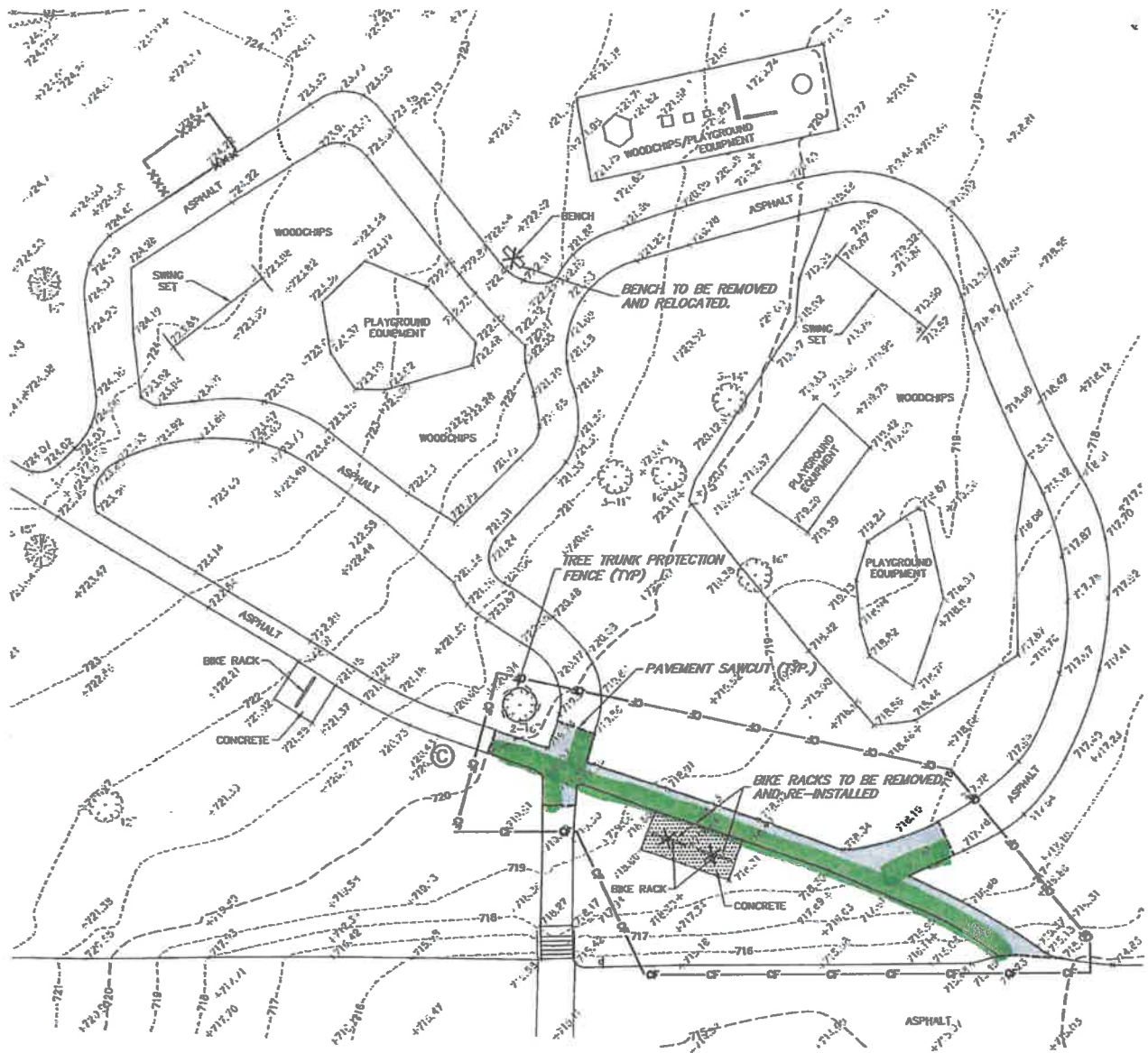

COPYRIGHT NOTICE

This drawing is the property of Gewalt-Hamilton Assoc., Inc. and is not to be used for any purpose other than the specific project and date noted herein, and cannot be reproduced in any manner without the express written permission from Gewalt-Hamilton Associates, Inc.



**LONGFELLOW PARK
EXISTING CONDITIONS/DEMOLITION PLAN**

REMOVAL LEGEND

-  HMA PAVEMENT REMOVAL - FULL DEPTH
-  PCC SIDEWALK REMOVAL
-  PAVEMENT SAWCUT
-  TEMPORARY CONSTRUCTION FENCE
-  TREE PROTECTION FENCE
-  CONCRETE WASHOUT
-  IMPROVEMENT TO BE REMOVED

 - AC

**VILLAGE OF
BUFFALO GROVE**



Engineering Department
Fifty One Raupp Blvd.
Buffalo Grove, IL 60089-2198
Fax 847-537-5845

Mark A. Biederwolf, P.E.
Civil Engineer II
Phone 847-459-2523
mbiederw@vbg.org

July 24, 2017

Mr. Tim Howe
Supt. of Parks & Recreation
BUFFALO GROVE PARK DISTRICT
530 Bernard Drive
Buffalo Grove, IL 60089

RE: CONCRETE WORK AT THE ALCOTT CENTER (530 Bernard Dr.)

Dear Tim:

Enclosed please find Invoice No. 2017-00000002 for the amount of \$10,524. This amount is for sidewalk, curb, detectable warning panels, and asphalt patching work.

The areas along the sidewalk edges have been backfilled with topsoil and seed. Please help water these areas so we can get some grass to grow.

If you have any questions, please contact me.

Very truly yours,

VILLAGE OF BUFFALO GROVE

A handwritten signature in black ink that reads "Mark A. Biederwolf".

Mark A. Biederwolf, P.E.
Civil Engineer II

G:\ENGINEER\MAB\455B.docx

***An Internationally Accredited
Public Works Agency
Since 2004***



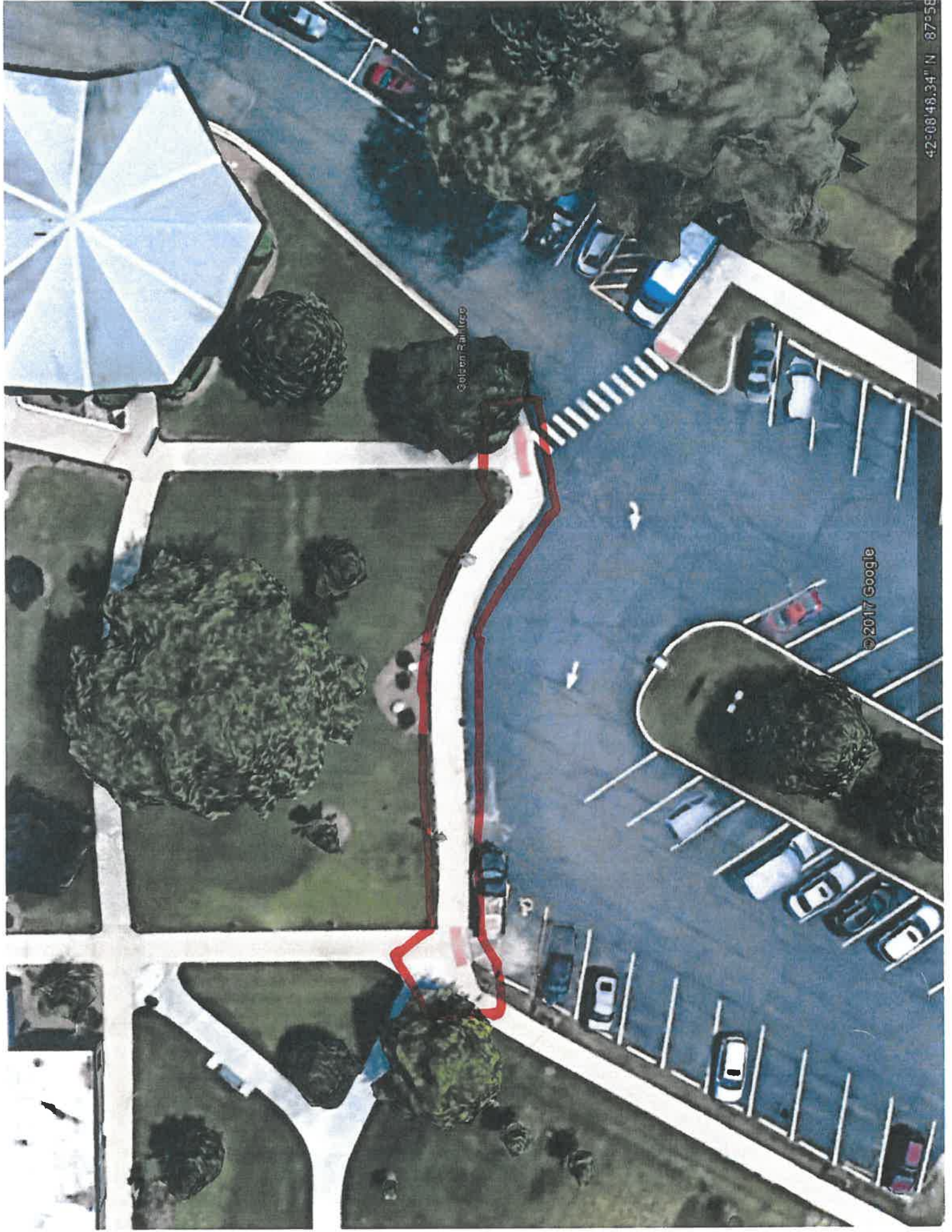

© 2017 Google

© 2017 Google

42°08'48.34" N 87°58'



December 9, 2016

Tim Howe, CPRP, CPSI
Director of Parks and Risk Management
Buffalo Grove Park District
530 Bernard Drive
Buffalo Grove, IL 60089

RE: Green Lake Park Fishing Deck

Dear Tim:

Thank you for considering Upland Design to assist the Park District with the fishing deck at Green Lake Park. I am pleased to submit a proposal for services as well as past project profiles for your review.

As a landscape architectural firm that specializes in public outdoor recreation, natural areas and park development we have the experience necessary to create a great deck. Our team brings a custom and collaborative approach to each project and will work closely with you for a successful project. The project will be lead by myself with the assistance of our landscape architectural staff.

Over the past 18 years we have created parks and open spaces that connect communities with their open spaces and natural areas to encourage everyone to go outside. We look forward to assisting the Buffalo Grove community in doing the same and are excited to discuss your needs further.

Sincerely,

A handwritten signature in black ink that reads "Michelle Kelly".

Michelle A. Kelly, PLA, CPSI
Principal Landscape Architect

Professional Service Fees

Phase I – Construction Documents	\$3,880
Structural Engineer Review & Stamp	\$ 800
Phase II - Permitting	\$ 354
Phase III – Bidding	\$ 756
Phase IV – Construction Administration	\$2,632
Total	\$ 8,422

Optional Services

Staff Meetings

3 included above (one is the bid opening)

add or deduct meetings \$ 524

Site Visits

4 included above

add or deduct site visit \$ 520

Reimbursables: In additoin to the fees above, reimbursablse items will be billed at their direct costs including: printing plans for review and bidding, delievery of docu-ments, and mielage at current IRS rates.



Boardwalk at Fox River - Batavia Park District

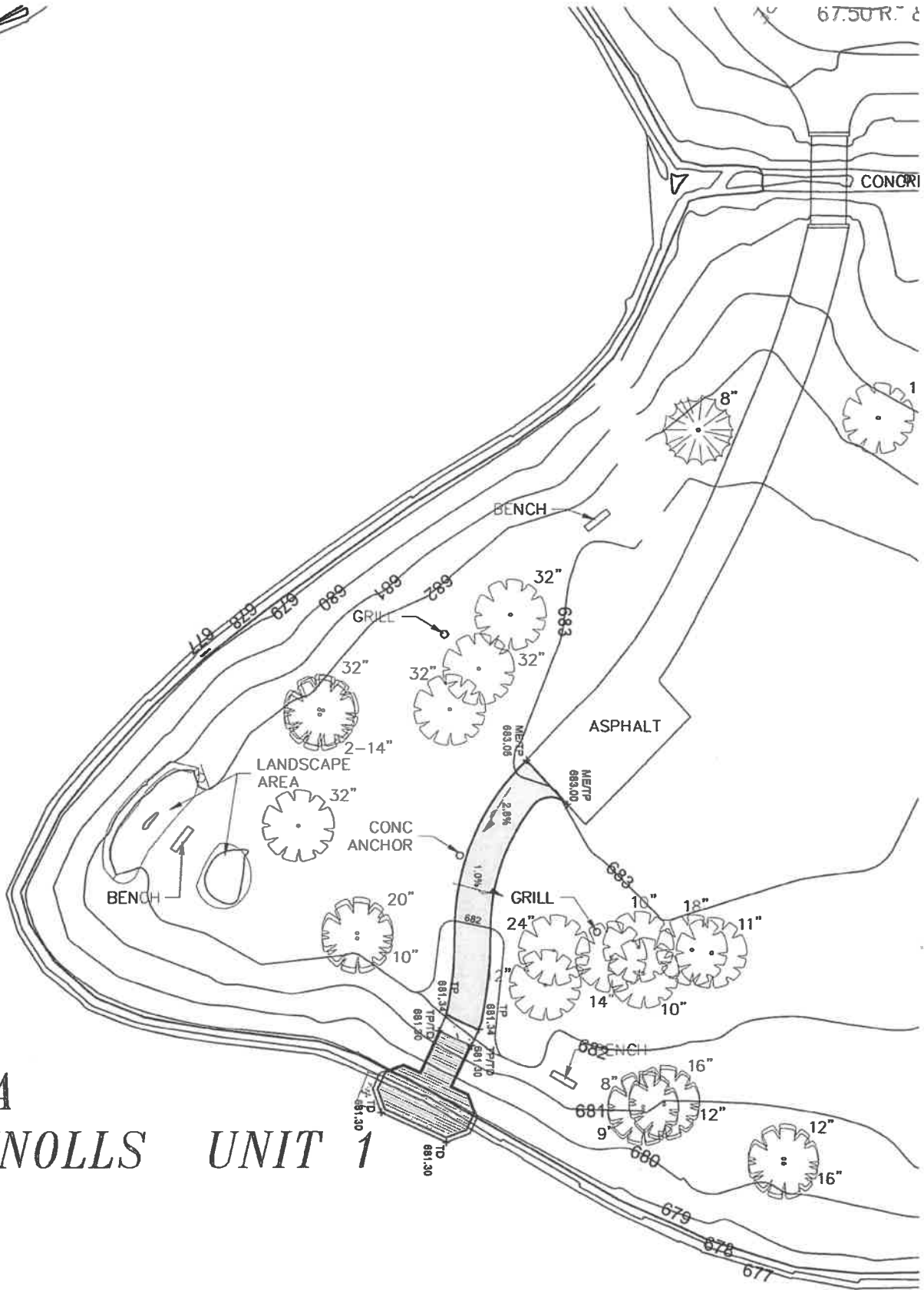

A KNOLLS UNIT 1

18.79 ACRES

LEGATARCHITECTS

SUSTAINABILITY | PERFORMANCE | DESIGN

February 7, 2017

VIA email

Mr. Ryan Risinger
Executive Director
Buffalo Grove Park District
530 Bernard Drive
Buffalo Grove, IL 60089

RE CAC – 2017 Interior Renovations
Architect's Project Number: 217011.00
ADA Reimbursement

Dear Mr. Risinger:

The Park District has requested a breakdown of the pricing related to the design and construction of ADA compliant components for the Community Arts Center renovation project. We spoke with the General Contractor and reviewed the Schedule of Values from Pay Application 3 to determine the following breakdown.

• ADA compliant Sidewalk/Curb Modifications for new entrance.	\$36,400
• ADA compliant Cabinets, Counters, and Benches	\$31,000
• ADA compliant Door Hardware	\$72,800
• ADA compliant recessed walkoff mat and floor transitions	\$15,000
• ADA compliant wheelchair lift for the Control Booth	\$28,000
• ADA compliant plumbing fixtures for the (2) toilet rooms	\$11,850
• ADA compliant electrical power/data devices	\$21,450
• A/E fees for Schematic Design which complies w/ ADA requirements	\$34,500
• A/E fees for Design Development which complies w/ ADA requirements	\$46,000

Based on the list above, our opinion is that a total amount of \$297,000 has been spent specifically for the design and construction of ADA compliant components for the Community Arts Center renovation project. If you have any questions please do not hesitate to call and thank you very much.

Sincerely,



Michael R. Maloney, LEED AP BD+C
Senior Associate, Creative/Sustainability Director
Legat Architects, Inc.

FILENAME LTR_20180207_ADA

