

Title	<b>Einstein Park</b>	05/23/2025
	by <b>Matthew Gaynor</b> in <b>Member District ADA</b>	id. 50612905
	<b>Project Request</b>	
	235 E. Beech Drive Schaumburg, Illinois 60193 United States 847.985.2115 magaynor@parkfun.com	

Original Submission

05/23/2025

Score	n/a
Name	Todd King
Job Title	Director of Parks & Planning
E-mail Address	toking@parkfun.com
Phone Number	847.985.2115
Park District	Schaumburg
Project Location	Einstein Park
Project Status	Alteration
Project Type	Recreation Facilities and Amenities Routes and Surfaces
Recreation Facilities and Amenities- select a Project Category below:	Playgrounds- Play Components
Routes and Surfaces- select a Project Category below:	Curb Ramps Play Surfaces Sidewalks Walking Surfaces
Benefits of the Project	As per the Schaumburg Park Districts master plan playground renovations are scheduled when equipment, surfacing, and amenities begin to become more difficult to maintain properly and provide a safe and accessible play experience. The scope of work involved the removal and replacement of playground equipment, safety surfacing, drainage, select concrete curbing, select pathways, and the installation of new seating areas.

Items that will become ADA Compliant	Playground Equipment, Safety Surfacing, Walking Surfaces, and Seating Areas
The project is designed or constructed, or applies human resources, to comply with:	The 2010 Standards for Accessible Design The 2013 Final Guideline for Outdoor Developed Areas Owned and Operated by the Federal Government ASTM F 1951 Standard for Accessible Playground Surfaces
Upload Project Related Files, Photos, Videos or Audio	
<a href="#">003_L-2.3_Einstein_Site_Plan_03.25.24.pdf</a>	
Budget Table for ADA Related Expenses	
<a href="#">Budget Table.xlsx</a>	
ADA Dollars Requested	599628.33
Notes related to requested amount	Please let us know if you have any questions or concerns. Thanks for your work.

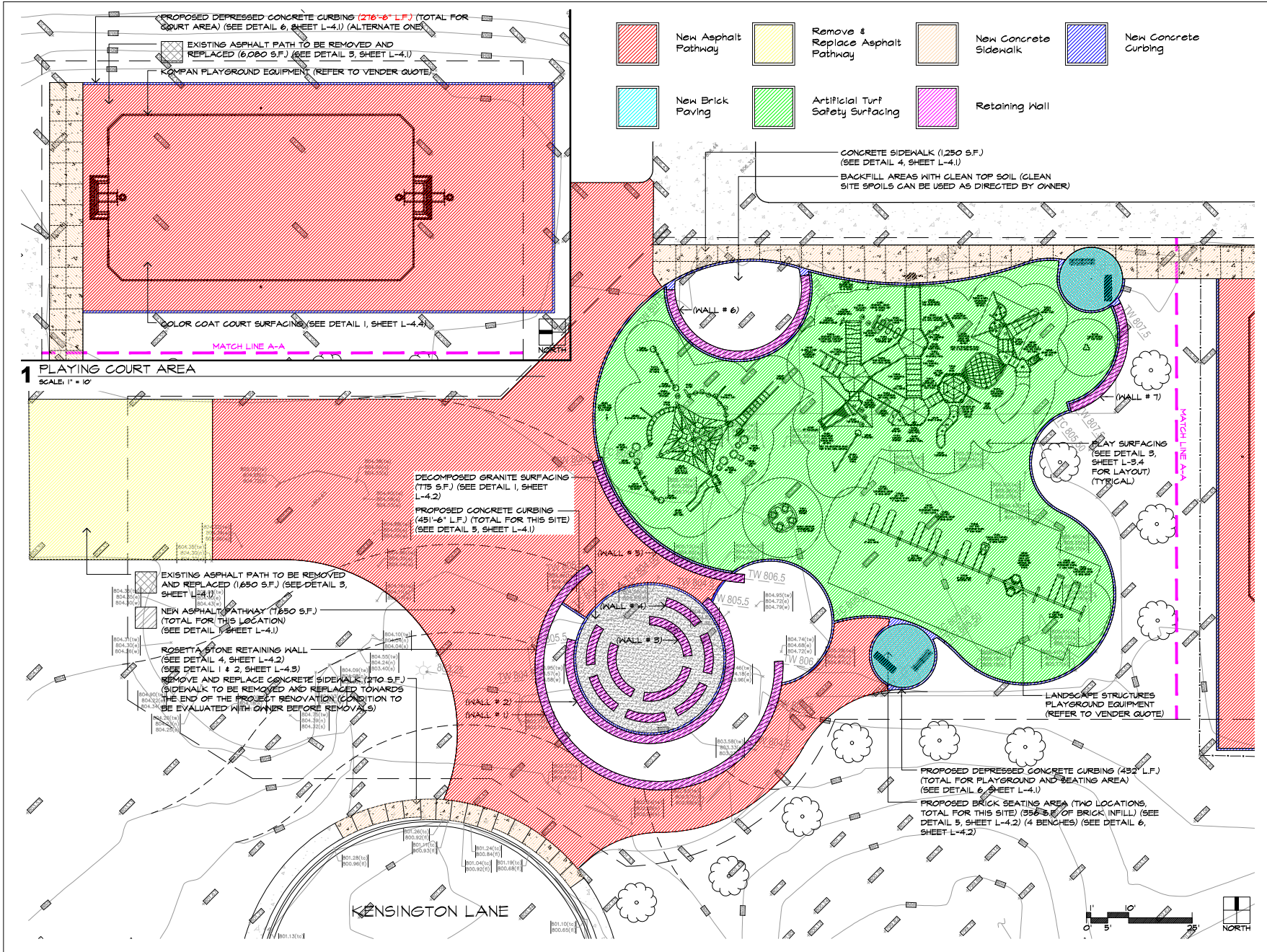

NOTES

- + EXISTING GRADE
- + PROPOSED GRADE
- CONSTRUCTION LIMITS
- TREE PROTECTION FENCING
- BM BENCH MARK (BASE OF SECURITY LIGHT)
- T.C. TOP OF CURB
- B.C. BOTTOM OF CURB
- T.W. TOP OF WALL
- B.W. BOTTOM OF WALL

ISSUED FOR BID 03.25.24  
DESCRIPTION DATE

2024 PLAYGROUND  
RENOVATIONS

EINSTEIN SCHOOL  
100 LAURIE LANE  
HANOVER PARK IL, 60103

DATE MARCH 25th, 2024  
SCALE 1" = 10'  
DRAWN BY MG  
APPROVED BY TK

SITE PLAN  
SHEET TITLE  
L - 2.3  
SHEET NUMBER

Project Type	Project Category	Project Category Cost	ADA Portion of Project	% ADA Dollars Requested
Routes and Surfaces	Play Surfaces	\$202,412.09	\$202,412.09	100.00%
Recreation Facilities and Amenities	Playgrounds- Play Components	\$521,165.60	\$208,466.24	40.00%
Recreation Facilities and Amenities	Playgrounds- Play Components	\$133,500.00	\$66,750.00	50.00%
Routes and Surfaces	Curb Ramps	\$43,500.00	\$21,750.00	50.00%
Routes and Surfaces	Sidewalks	\$28,500.00	\$14,250.00	50.00%
Routes and Surfaces	Walking Surfaces	\$15,500.00	\$15,500.00	100.00%
Routes and Surfaces	Walking Surfaces	\$39,000.00	\$19,500.00	50.00%
Routes and Surfaces	Walking Surfaces	\$51,000.00	\$51,000.00	100.00%
			<b>Total Project Cost</b>	\$1,034,577.69
			<b>Total ADA Portion of Project Cost</b>	\$599,628.33
			<b>Total % of ADA Dollars Requested</b>	57.96%