

Title	<b>Rec Plex</b>	03/27/2023
	by <b>Ben Kutscheid</b> in <b>Member District ADA Project Request</b>	id. 36116839
	1000 W. Central Road Mount Prospect, Illinois 60056 IL United States 847.255.5380 ext 108 bkutscheid@mppd.org	

## Original Submission 03/27/2023

Name	<b>Ben Kutscheid</b>
Job Title	<b>Planner/Landscape Architect</b>
E-mail Address	<b>bkutscheid@mppd.org</b>
Phone Number	<b>8472175076</b>
Park District	<b>Mt. Prospect</b>
Project Location	<b>Rec Plex</b>
Project Status	<b>Alteration</b>
Project Type	<b>Routes and Surfaces</b>
Routes and Surfaces- select a Project Category below:	<b>Ramps Walking Surfaces</b>
Benefits of the Project	<b>Adding railing to existing ramp to create accessible route, Replace flooring with accessible flooring</b>
Items that will become ADA Compliant	<b>Route to Rec Plex Amenities will become compliant</b>
The project is designed or constructed, or applies human resources, to comply with:	<b>The 2010 Standards for Accessible Design</b>

Upload Project Related Files, Photos, Videos or Audio

- [5\\_1\\_2023\\_Rec\\_Plex\\_Ramp\\_and\\_Corridor\\_1.pdf](#)
- [5\\_1\\_2023\\_Rec\\_Plex\\_Ramp\\_and\\_Corridor\\_2.pdf](#)
- [5\\_1\\_2023\\_Rec\\_Plex\\_Ramp\\_and\\_Corridor\\_3.pdf](#)
- [5\\_1\\_2023\\_Rec\\_Plex\\_Ramp\\_and\\_Corridor\\_4.pdf](#)
- [5\\_1\\_2023\\_Rec\\_Plex\\_Ramp\\_and\\_Corridor\\_5.pdf](#)
- [5\\_1\\_2023\\_Rec\\_Plex\\_Ramp\\_and\\_Corridor\\_6.pdf](#)
- [5\\_1\\_2023\\_Rec\\_Plex\\_Ramp\\_and\\_Corridor\\_7.pdf](#)
- [5\\_1\\_2023\\_Rec\\_Plex\\_Ramp\\_and\\_Corridor\\_8.pdf](#)
- [5\\_1\\_2023\\_Rec\\_Plex\\_Ramp\\_and\\_Corridor\\_9.pdf](#)
- [5\\_1\\_2023\\_Rec\\_Plex\\_Ramp\\_and\\_Corridor\\_10.pdf](#)

---

Budget Table for ADA Related Expenses

[Budget Table.xlsx](#)

---

ADA Dollars Requested	<b>27385.0</b>
-----------------------	----------------

---

Notes related to requested amount	<b>I am leaving the Mt. Prospect Park District, my last day here is March 30 - Please contact Nick Troy or Jim Jarog with any questions.</b>
-----------------------------------	--

---



May 1, 2023

Ms. Tracey Crawford, CTRS, CPRP, Executive Director  
Northwest Special Recreation Association  
3000 Central Rd. - Suite 205  
Rolling Meadows, IL 60008

Re: NWSRA Authorization of use of Accessibility Fund  
RecPlex Ramp and Corridor

Dear Tracey,

The Mount Prospect Park District Rec Plex (420 Dempster, Mt. Prospect, IL 60056) is a Recreation Center on the Southwest side of the Park District. The Park District intends to replace and upgrade the flooring in the Hallway and ramp leading from the main desk and too the Pool and install railing on existing ramp slopes. We recommend the following funds be authorized for use for the Mt. Prospect Park District for Accessibility improvements. The funds will be paid to a contractor through the Park District.

The Park District is proposing to install the Mohawk Industries – Premium Wood - Luxury Vinyl Tile 2.5mm thick. The Vinyl Tile meets ADA code for slip resistance complying with ASTM F1700 Class III type A and is firm and stable and slip resistant surface.

The total floor area for replacement is 3342 sf.

Request reimbursement for 5' corridor width for main pathway through from the intake desk to the pool. The total pathway and ramp and clear floor space at doorways and drinking fountain is 1,206 sf. The square foot cost of the ramp and hallway is . The pathway shall meet the current ADA Standards (2010) and Accessibility as determined in Chapter 4 Accessible Routes 402 accessible Routes 403 Walking Surfaces including 403.5.3 Passing Space.

Request reimbursement for Accessible ramp railing to bring the ramp into compliance. This shall include 52 lf of steel pipe railing on both sides of the ramp. The handrails shall meet the current ADA Standards (2010) and Accessibility as determined in Chapter 5 Handrails 505. The total invoice for adding 52 lineal feet of accessible railing is \$6,900.

The Park District request authorization of the use of the Accessibility Fund for 1406 sf of flooring or 42% of \$48,773 for a request of **\$20,485** and Accessible Ramp Railing in the amount of **\$6,900** for a total of **\$27,385**

The Mt. Prospect Park District request **\$27,385.00** for authorization of use of Accessibility Fund for accessibility improvements made as part of the RecPlex corridor to racquetball and the pool flooring and ramp railing. The total projected project cost including ADA and non ADA items is 55,673.00.

Ben Kutscheid, ASLA, PLA, CPSI  
Planner / Landscape Architect

Cc: Jessica Vasalos. Northwest Special Recreation Association  
Jim Jarog, Mt. Prospect Park District  
Nick Troy, Mt. Prospect Park District

Rec Plex Corridor Flooring and Ramp Railing  
Mt. Prospect Park District

May 1, 2023

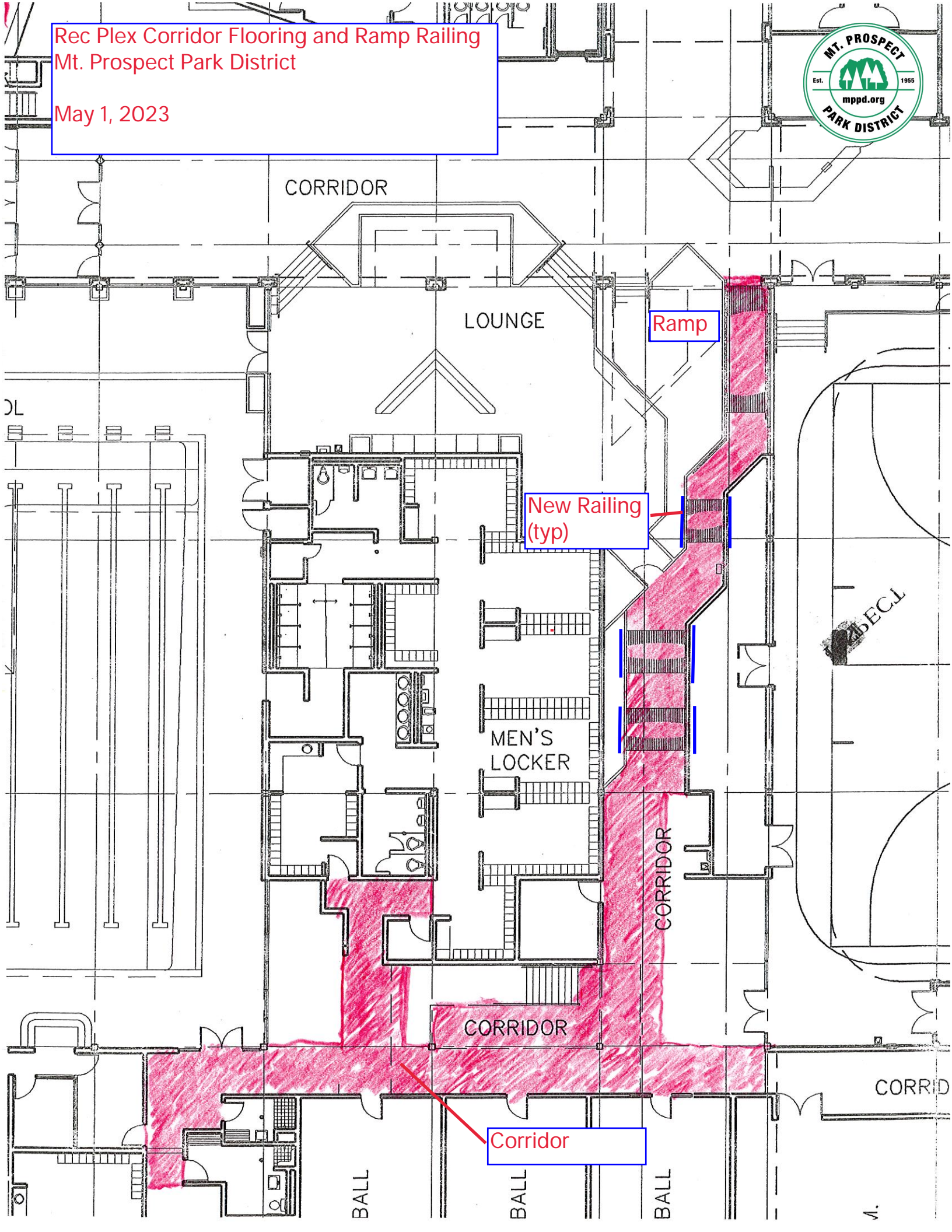

CORRIDOR

LOUNGE

Ramp

New Railing  
(typ)

MEN'S  
LOCKER

CORRIDOR

CORRIDOR

Corridor

BALL

BALL

BALL

CORRID

1.





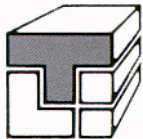

# PROPOSAL

## Trevino Flooring

470 W. Hintz Road • Wheeling, IL 60090

Phone 847-808-7100 • Fax 847-808-7101

www.trevinoflooring.com

No: **P-34014**

Date: **11/23/2022**

### SALES • SERVICE • INSTALLATION • CLEANING

#### Proposal Submitted To:

REC PLEX - MT. PROSPECT PD  
420 W. DEMPSTER ST.  
MT. PROSPECT, IL 60056  
ATTN: Nick Troy  
Phone: 847-640-1000      FAX:

#### Work To Be Performed At:

Ramp / Racquet Courts

Date of Plans

We hereby propose to furnish the materials and perform the labor necessary for the completion of

**Project: Luxury Vinyl Plank Installation**

**Area: Ramp, Racquet Ball Corridor, Staircase, Landing**

**Service includes: Take up / Haul away existing flooring, Floor Prep, Provide & Install Living Local Premium Wood C0194 ( Color 096 Shadow ) , Provide and Install Vinyl Cove base, transitions and stair nosing where needed.**

**\*\* Job detail on attached excel sheet.**

**Total: \$48,764.02**

**\*\*Sourcewell Code #080819-MCD**

All material is guaranteed to be as specified, and the work to be performed in accordance with the drawings and specifications submitted for above work and completed in a substantial workmanlike manner for the sum of \$48,764.02 with payments to be made as follows:

50% Deposit Requested  
Balance Due on completion

Any alteration or deviation from above specifications involving extra costs, will be executed only upon written orders, and will become an extra charge over and above the estimate. All agreements contingent upon strikes, accidents or delay beyond our control. Owner to carry fire, tornado and other necessary insurance upon above work. Workmen's Compensation and Public Liability Insurance on above work to be taken out by General Casualty

Respectfully Submitted    Shawn Trevino

Note - This proposal may be withdrawn by us if not accepted within 45 days.

#### ACCEPTANCE OF PROPOSAL

The above prices, specifications and conditions are satisfactory and are hereby accepted. You are authorized to do the work as specified. Payment will be made as outlined above.

Signature \_\_\_\_\_

Date \_\_\_\_\_

Signature \_\_\_\_\_



# J.B. METAL WORKS, INC.

1325 LEE STREET  
 DES PLAINES, IL. 60018  
 PHONE 1-847-824-4253

# PROPOSAL

Date: 2/28/2023  
 Estimate #: 8076

**Name / Address**

Mt. Prospect Park District  
 1645 Carboy St  
 Mt. Prospect, Il 60056

**PHONE**

847-255-5380X108

Description	Qty	Rate	Total
ATTN: BEN KUTSCHEID, JOBSITE: CENTRAL COMMUNITY CENTER 1000 W. CENTRAL ROAD MT. PROSPECT, IL. 60056			
CUSTOM FABRICATED TUBULAR RAILINGS AT INTERIOR RAMP AREA 1-1/4 IN. SCHEDULE 40 PIPE, (1-5/8 OD.) 12 INCH LEVEL ADA EXTENSIONS AT BOTH ENDS FREE STANDING RAILINGS 1 EA. APPROXIMATELY 10 FT. 2 EA. APPROXIMATELY 8 FT.		5,550.00	5,550.00
WALL MOUNT HANDRAILINGS 1 EA. APPROXIMATELY 10 FT. 2 EA. APPROXIMATELY 8 FT.			
ONE COAT OF SHOP PRIMER INSTALLED			
SANDBLASTED, PRIMED AND POWDER COATED SATIN BLACK ADDITIONAL: POWDER COAT RAL 6021 PALE GREEN OR SIMILAR		1,100.00 250.00	1,100.00 250.00

THIS PROPOSAL MAY BE REVISED OR WITHDRAWN BY JB METAL WORKS IF NOT ACCEPTED WITHIN 30 DAYS

SIGN AND RETURN ONE COPY UPON ACCEPTANCE 3.6 2023 DATE

X \_\_\_\_\_

*B B Kutsch*  
 BKUTSCHEID@MPD.ORG  
 847.255.5380 EXT 108  
 Fax # E-mail

**Subtotal** \$6,900.00  
**Sales Tax** \$0.00  
**Total** \$6,900.00

Signature *BK*

Web Site [www.JBMetalWorks.com](http://www.JBMetalWorks.com)

847-824-7958

steve@JBMetalWorks.com

Project Type (From ab	Project Category (From Above)	Media File #/Name	Project Category Cost	ADA Portion of Project Cate	% ADA Dollars Requested
Routes and Surfaces	walking surfaces	5_1_2023_Rec_Plex_Ran	48773	20485	42.00%
Routes and Surfaces	ramps	5_1_2023_Rec_Plex_Ran	6900	6900	100.00%

#DIV/0!  
#DIV/0!  
#DIV/0!  
#DIV/0!  
#DIV/0!  
#DIV/0!  
#DIV/0!  
#DIV/0!  
#DIV/0!  
#DIV/0!  
#DIV/0!  
#DIV/0!  
#DIV/0!  
#DIV/0!  
#DIV/0!  
#DIV/0!  
#DIV/0!  
#DIV/0!  
#DIV/0!

Total Project Cost	55673
Total ADA Portion of Project Cost	27385
Total % of ADA Dollars Requested	49.19%