

| | | |
|-------|--|--------------|
| Title | Olympic Park | 05/27/2025 |
| | by Matthew Gaynor in Member District ADA | id. 50637097 |
| | Project Request | |
| | 235 E. Beech Drive Schaumburg, Illinois 60193 United States 847.985.2115 magaynor@parkfun.com | |

Original Submission

05/27/2025

| | |
|---|--|
| Score | n/a |
| Name | Todd King |
| Job Title | Director of Parks & Planning |
| E-mail Address | toking@parkfun.com |
| Phone Number | 847.985.2115 |
| Park District | Schaumburg |
| Project Location | Olympic Park |
| Project Status | New Alteration Maintenance |
| Project Type | Recreation Facilities and Amenities Routes and Surfaces |
| Recreation Facilities and Amenities- select a Project Category below: | Playgrounds- Play Components |
| Routes and Surfaces- select a Project Category below: | Sidewalks Walking Surfaces |

| | |
|---|---|
| Benefits of the Project | <p>This was completed using a Tourism Grant from the State of Illinois. The purpose was to provide much needed shade opportunities at all of our artificial turf soccer fields (Fields 1-9). The new shelters conform to current ADA standards.</p> <p>The scope of work also involves a variety of replacement/renovation of asphalt and concrete surfacing with a variety of cracks greater than ½” and rise greater than ¼”. New asphalt pathway surfacing was installed that conforms to current ADA standards.</p> |
| Items that will become ADA Compliant | <p>Two new 10’ x 30’ fabric cantilever shade structures installed on Olympic Park Soccer Fields 1-9. (18 shades total)</p> <p>Various Asphalt Pathways</p> |
| The project is designed or constructed, or applies human resources, to comply with: | The 2010 Standards for Accessible Design |
| Upload Project Related Files, Photos, Videos or Audio 020_Site_Plan_Shelters_and_Pathways_11.20.23.pdf | |
| Budget Table for ADA Related Expenses Budget Table.xlsx | |
| ADA Dollars Requested | 363612.5 |
| Notes related to requested amount | Please let us know if you have any questions or concerns. Thanks for your work. |

NOTES

- New Asphalt Pathway
- Remove & Replace Asphalt Pathway
- New Concrete Sidewalk

ISSUED FOR BID 11/20/23
DESCRIPTION DATE

OLYMPIC PARK
SUN SHADE PROJECT

OLYMPIC PARK
1675 E. OLD SCHAUMBURG RD
SCHAUMBURG IL, 60193

DATE NOVEMBER 20, 2023
SCALE AS NOTED
DRAWN BY MG
APPROVED BY TK

SITE PLAN

SHEET TITLE

L - 1.1

SHEET NUMBER

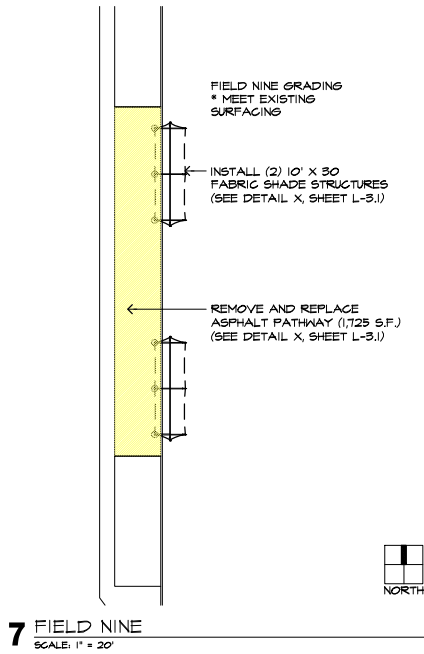
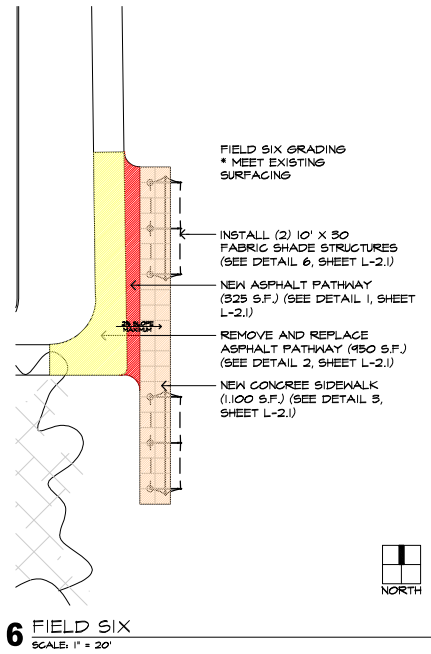
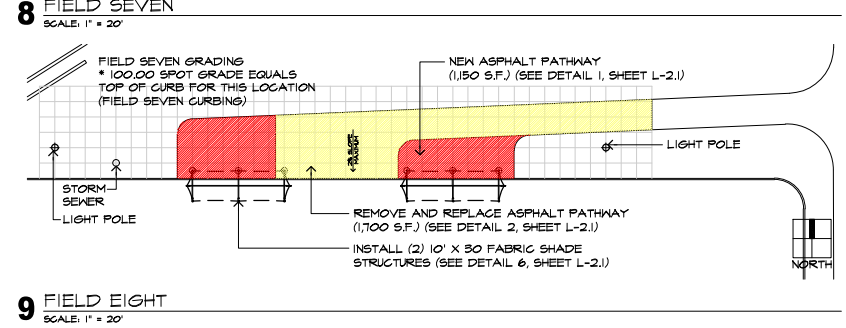
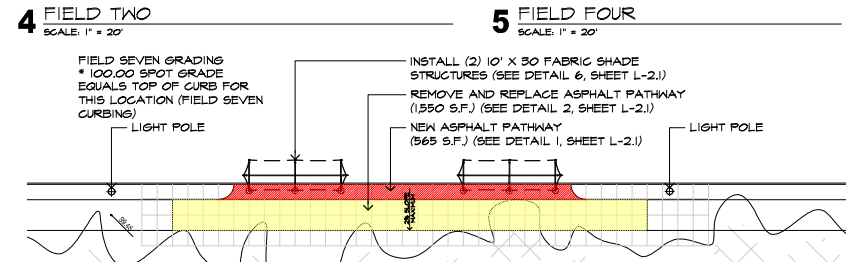
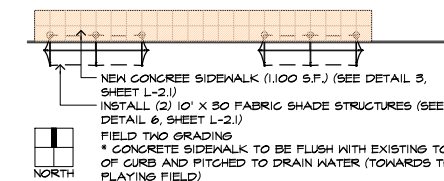
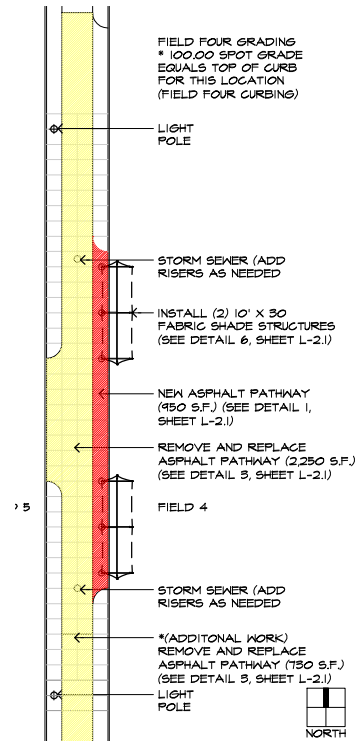
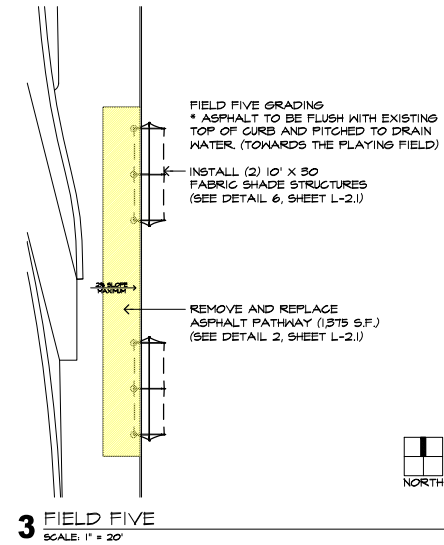
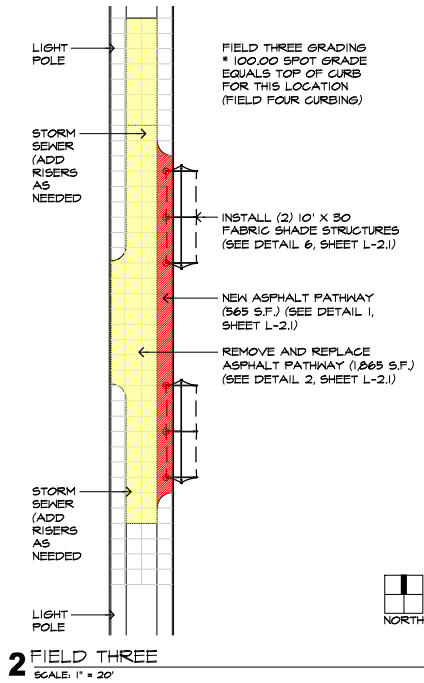
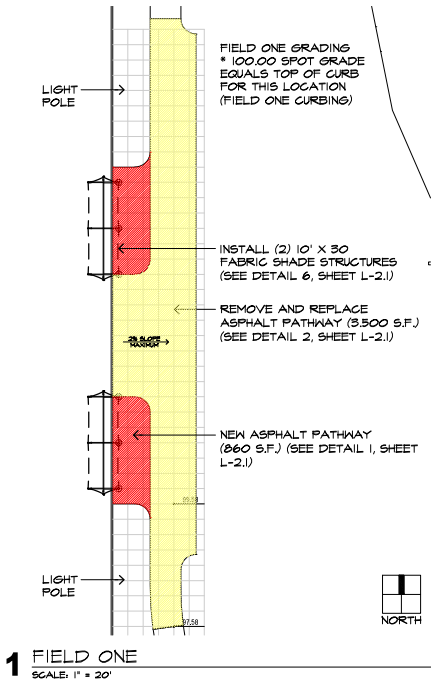

| Project Type | Project Category | Project Category Cost | ADA Portion of Project | % ADA Dollars Requested |
|-------------------------------------|------------------------------|-----------------------|--|-------------------------|
| Recreation Facilities and Amenities | Playgrounds- Play Components | \$277,700.00 | \$277,700.00 | 100.00% |
| Routes and Surfaces | Walking Surfaces | \$171,825.00 | \$85,912.50 | 50.00% |
| | | | Total Project Cost | \$449,525.00 |
| | | | Total ADA Portion of Project Cost | \$363,612.50 |
| | | | Total % of ADA Dollars Requested | 80.89% |