

Title	Robert Frost Park / School	06/24/2022
	by Ben Kutscheid in Member District ADA Project Request	id. 27479153
	1000 W. Central Road Mount Prospect, Illinois 60056 United States 847.255.5380 ext 108 bkutscheid@mppd.org	

Original Submission 06/24/2022

Name	Ben Kutscheid
Job Title	Planner/Landscape Architect
E-mail Address	bkutscheid@mppd.org
Phone Number	8472555380 ext 108
Park District	Mt. Prospect
Project Location	Robert Frost Park / School
Project Status	Alteration New
Project Type	Recreation Facilities and Amenities Routes and Surfaces
Recreation Facilities and Amenities- select a Project Category below:	Benches- Picnic Tables Playgrounds- Play Components
Routes and Surfaces- select a Project Category below:	Accessible Routes- Means of Egress Walking Surfaces Stairways Play Surfaces
Benefits of the Project	Installation of playground including PIP resilient surface. The work also includes asphalt paving and concrete walkway work as well as park amenities.
Items that will become ADA Compliant	The playground and play surface, walking paths and amenities.

The project is designed or constructed, or applies human resources, to comply with:

**The 2010 Standards for Accessible Design
ASTM F 1951 Standard for Accessible Playground Surfaces**

Upload Project Related Files, Photos, Videos or Audio

[Frost_1.pdf](#)

[Frost_2.pdf](#)

[Frost_3.pdf](#)

[Frost_4.pdf](#)

[Frost_5.pdf](#)

[Frost_6.pdf](#)

Budget Table for ADA Related Expenses

[Budget Table.xlsx](#)

ADA Dollars Requested	240553.3
-----------------------	-----------------

Notes related to requested amount	Per tele discussion with Tracey and Andrea on 6/16
-----------------------------------	---



July 1, 2022

Ms. Tracey Crawford, CTRS, CPRP, Executive Director
Northwest Special Recreation Association
3000 Central Rd. - Suite 205
Rolling Meadows, IL 60008

Re: NWSRA Authorization of use of Accessibility Fund
Robert Frost Park/School Redevelopment

Dear Tracey,

Robert Frost Park Playground (1308 Cypress, Mt. Prospect, IL 60056) is a neighborhood School/Park located on the Southwest side of the Park District. We recommend the following funds be authorized for use by the Mt. Prospect Park District for Accessibility improvements. The funds will be used for playground and general park construction.

The first items are related to the play area replacement. The play area meets and exceeds current ADA Standards (2010). The play equipment was approved at the NWSRA May board meeting at an accessibility of 80%. The Playground Accessibility is as determined in Chapter 2 Scoping Requirements 240 Play Areas and Chapter 10 Recreation Facilities 1008 Play Areas.

- 1) Request authorization for 50% of the cost for play area removal. The cost to remove the play area is \$2,000. We request authorization for the Park District to use ADA funds in the amount of **\$1,000.**
- 2) Request reimbursement for 80% of the cost of labor to install the new play equipment. The cost of the labor is \$33,685.05. We request authorization for the Park District to use ADA funds in the amount of **\$26,984.04.**
- 3) Request authorization for the cost of 5,650 sf resilient surface. The Park District is proposing to install a resilient surface that is all "Poured in Place Rubber". The surface shall meet the current ADA Standards (2010) and Accessibility as determined in Chapter 2 Scoping Requirements 206.2.2 Accessible Route within a Play Area Chapter 3 Building Blocks 305.2 Floor and Ground Surfaces. We request authorization for the Park District to use ADA funds in the amount of **\$172,891.26**
- 4) Request authorization for 5' concrete pathway width and table clear floor space which is about 50% of 2066 sf concrete pad new concrete walk and picnic table pad in the center of the play area. The cost for the concrete walk and the concrete pad is \$22,726. The concrete pad shall meet the current ADA Standards (2010) and Accessibility as determined in Chapter 2 Scoping Requirements 206.2.2 Accessible Route within a site Chapter 4 Accessible Routes 403 Walking Surfaces and Chapter 9 Built in Elements 902.2 Dining Surfaces Clear Floor Space. We request authorization for the Park District to use ADA funds in the amount of **\$11,363.00**

5) Request reimbursement for 50% of cost of an ADA picnic table and 2 ADA Benches. The cost of one installed picnic table is \$4,400 the cost 2 ADA benches is \$3,400. The ADA Picnic Tables shall meet the current ADA Standards (2010) and Accessibility as determined in Chapter 2 Scoping Requirements 226 Dining Surfaces and in Chapter 9 Built in Elements 902 Dining Surfaces. The ADA Picnic Tables shall meet the current ADA Standards (2010) and Accessibility as determined in Chapter 2 Scoping Requirements, Chapter 9 Built in Elements 903 Benches. We request authorization for the Park District to use ADA funds in the amount of **\$3,900**.

6) Request authorization for 5' of pathway width and 1190 lineal feet of new path. We are adding 11,499 sf of asphalt paving for a paving total of \$42,514.80. The asphalt shall meet the current ADA Standards (2010) and Accessibility as determined in Chapter 2 Scoping Requirements 206.2.2 Accessible Route within a site Chapter 4 Accessible Routes 402 accessible Routes 403 Walking Surfaces including 403.5.3 Passing Space. We request authorization for the Park District to use ADA funds in the amount of **\$22,015**

7) Request authorization for clear floor space at 2 benches. The cost for the 2 bench pads is \$1,200. The bench pads shall meet current ADA Standards (2010) and Accessibility as determined in Chapter 9 Built In Elements 903.2 Clear Floor Space or Ground Space for Benches. We request authorization for the Park District to use ADA funds in the amount of **\$2,400**

We request authorization by the NWSRA for the Park District to use ADA funds in the amount of **\$ 240,553.30** for reimbursement from the NWSRA for accessibility improvements made as part of the Robert Frost Park Redevelopment. The total cost of work for Robert Frost Redevelopment is \$368,891.11

Ben Kutscheid, ASLA, PLA, CPSI
Planner / Landscape Architect

Cc: Jessica Vasalos, Northwest Special Recreation Association
Jim Jarog, Mt. Prospect Park District
Matt Dziubinski, Mt. Prospect Park District

Central Community Center
1000 W. Central Rd.
Mount Prospect, IL 60056
847-255-5380

RecPlex
420 W. Dempster St.
Mount Prospect, IL 60056
847-640-1000

Lions Recreation Center
411 S. Maple St.
Mount Prospect, IL 60056
847-632-9333

Friendship Park Conservatory
395 W. Algonquin Rd.
Des Plaines, IL 60018
847-298-3500

Mt. Prospect Golf Club
600 See-Gwun Ave.
Mount Prospect, IL 60056
847-259-4200

Our Mission:

To provide exceptional parks and recreation experiences that enrich the quality of life for present and future generations

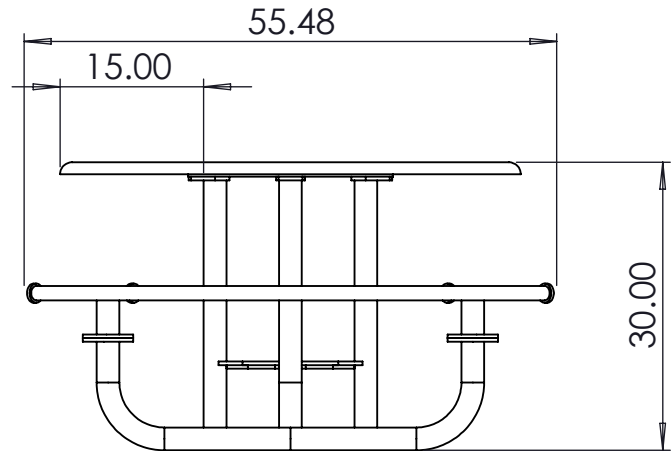
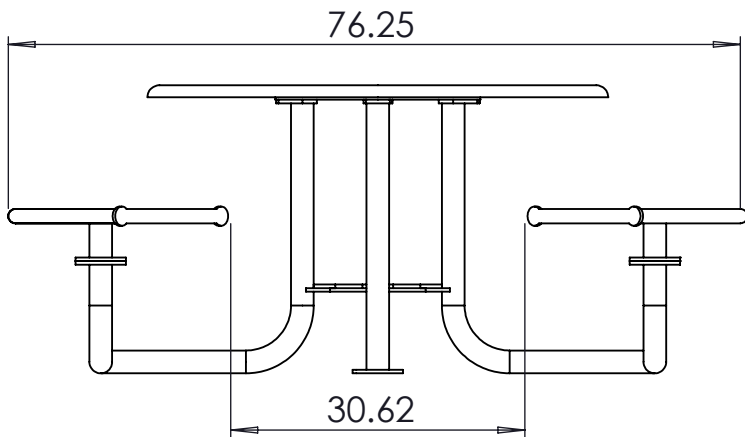
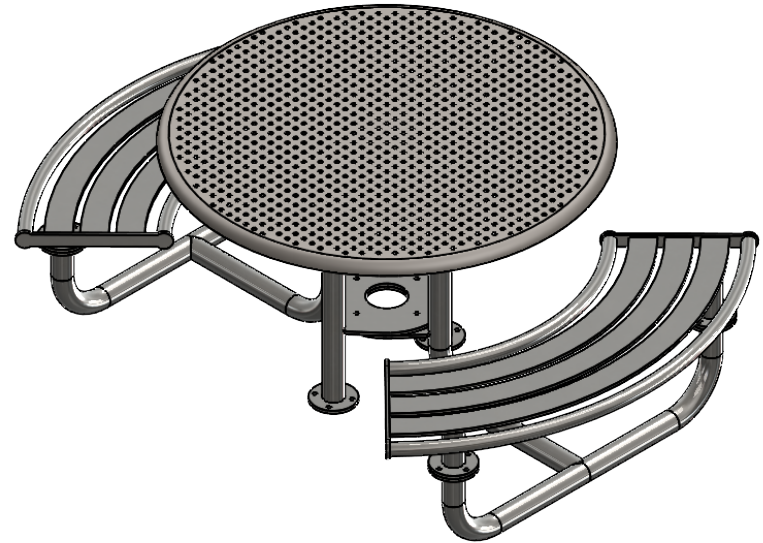
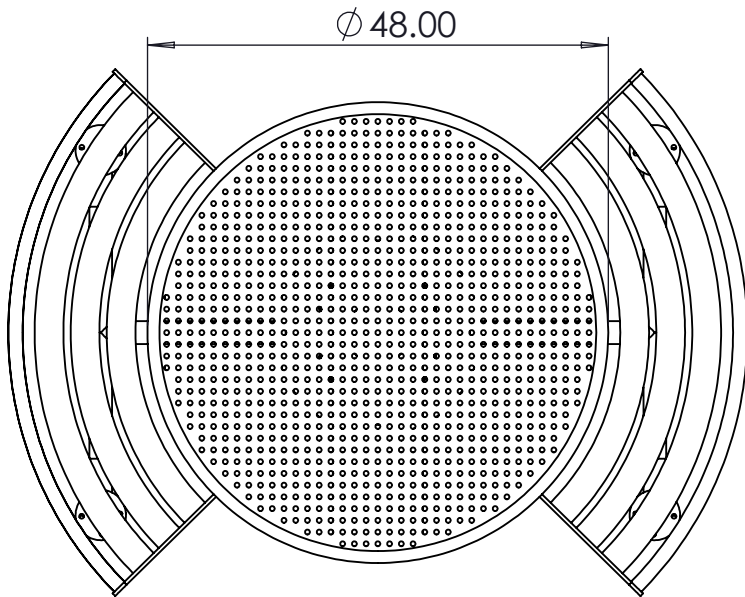

KEYSTONE RIDGE DESIGNS, INC®
 670 MERCER ROAD
 BUTLER, PA 16001
 PHONE: 1-800-284-8208
 FAX: (724) 284-1253
 www.keystoneridgedesigns.com

UNLESS OTHERWISE SPECIFIED:

DIMENSIONS ARE IN INCHES
 TOLERANCES:
 FRACTIONAL ± 1/16
 ANGULAR/BEND ± 1°
 TWO PLACE DECIMAL ± .030
 THREE PLACE DECIMAL ± .020

MATERIAL

FINISH

DO NOT SCALE DRAWING

DRAWN	NAME	DATE
CHECKED	CJC	5/23/2022

EXCLUSIVE BY DESIGN™

PROPRIETARY AND CONFIDENTIAL
 THE INFORMATION CONTAINED IN THIS DRAWING IS THE SOLE PROPERTY OF KEYSTONE RIDGE DESIGNS. ANY REPRODUCTION IN PART OR AS A WHOLE WITHOUT THE WRITTEN PERMISSION OF KEYSTONE RIDGE DESIGNS IS STRICTLY PROHIBITED.

TITLE:
**PENN TABLE SET 48" RND
 PERFERATED ADA**

SIZE	DWG. NO.	REV
A	PNCU6-1-48"ADA	-

SCALE: 1:20	WEIGHT:	SHEET 1 OF 1
-------------	---------	--------------



© 2021 Keystone Ridge Designs, Inc.
All Rights Reserved.



