

Project Location	Nelson Sports Complex, 3900 Owl Drive Rolling Meadows IL 60008	12/20/2018
	by ADA Projects in Member District ADA Project Request	id. 11880034
	ADAprjects@rmparks.org	

Original submission	12/20/2018
----------------------------	------------

Name	Amy Charlesworth
Job Title	Executive Director
E-mail Address	ADAprjects@rmparks.org
Phone Number	847-818-3220
Park District	Rolling Meadows
Project Status	New
Project Type	Routes and Surfaces
Routes and Surfaces- select a Project Category below:	Accessible Routes- Means of Egress Curb Ramps Parking Spots Sidewalks
Benefits of the Project	RM Park District did a complete replacement of the south parking lot at Nelson Sports Complex. The parking lot was in disrepair, at the same time, we installed a sidewalk at the south parking lot not to only provide a safe ADA compliant access route to the facility but will also to create a route to the playground at South Salk Park. This will provide access for an individual or groups with a disability that may be using the facility for individual purposes or for planned NWSRA activities.
Items that will become ADA Compliant	Delectable warning 5" sidewalk Concrete curb and gutter Handicapped parking symbol

The project is designed or constructed, or applies human resources, to comply with:

**The 2010 Standards for Accessible Design
The Illinois Accessibility Code
Agency's ADA Transition Plan**

Upload Project Related Files, Photos, Videos or Audio

[1._NSC_Parking_Lot_sidewalk_Chadwick_Bill.pdf](#)

[NSC_Parking_Lot_Sidewalk_AIA_change_order_relating_to_ADA.pdf](#)

[NSC_Parking_Lot_Sidewalk_photos.pdf](#)

[NSC_Parking_Lot_Sidewalk_plans.pdf](#)

Budget Table for ADA Related Expenses

[01519a5c-9f19-4b25-96c9-b1ad3274e067.xlsx](#)

ADA Dollars Requested	44666.40
-----------------------	-----------------

Notes related to requested amount

The overall project cost was \$216,762.17. While we are requesting 100% of the project category, the percentage of the total project as it relates to ADA compliance is 20%. The curbs and gutters and ramps are only related to the west side of the project where the sidewalk was installed (a visual is on attachment #4). The east side only has wheel stops no additional work.

REFER TO SHEET 9

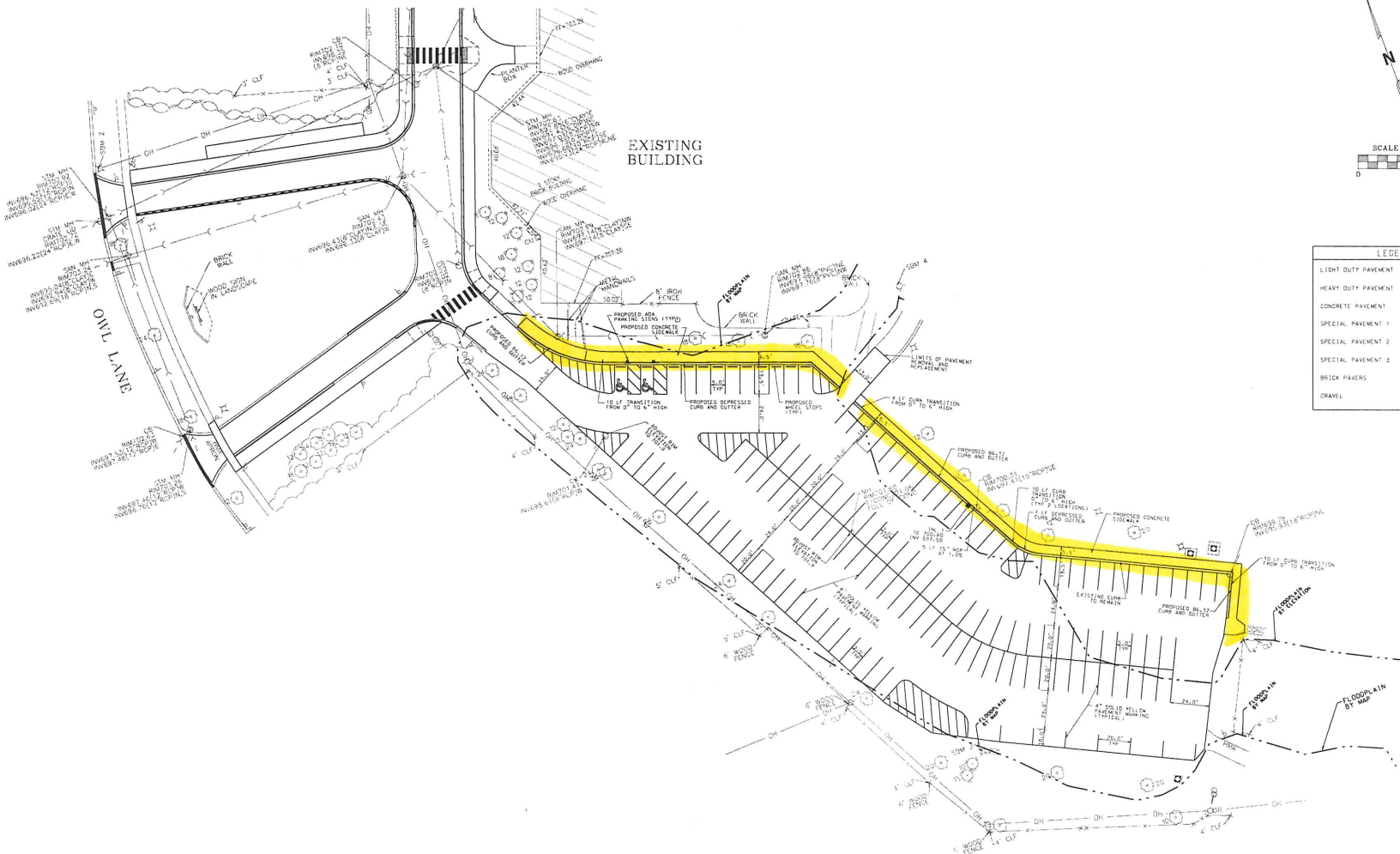

LEGEND

LIGHT DUTY PAVEMENT	[Pattern]
HEAVY DUTY PAVEMENT	[Pattern]
CONCRETE PAVEMENT	[Pattern]
SPECIAL PAVEMENT 1	[Pattern]
SPECIAL PAVEMENT 2	[Pattern]
SPECIAL PAVEMENT 3	[Pattern]
BRICK PAVERS	[Pattern]
GRAVEL	[Pattern]

REFER TO SHEET 9
FOR GENERAL NOTES

Mackie Consultants, LLC
 9575 W. Higgins Road, Suite 500
 Rosemont, IL 60018
 (847) 695-1400
 www.mackieconsult.com

CLIENT



3000 Central Road
 Rolling Meadows, IL 60008
 Phone: 847-515-3220

DATE	DESCRIPTION OF REVISION	BY	SCALE

DESIGNED	M/S
DRAWN	WHM
APPROVED	TKB
DATE	03-20-15
SCALE	1" = 30'

GEOMETRIC AND PAVING PLAN - SOUTH
NELSON SPORTS COMPLEX
ROLLING MEADOWS, ILLINOIS

SHEET
10 OF 12
 PROJECT NUMBER 2432
 © MACKIE CONSULTANTS LLC 2015
 ILLINOIS FIRM LICENSE 184-022651

1/10/2015 1:53:27 PM
 C:\PROJECTS\2015\2432\DRAWINGS\2432-10.DWG

Rolling Meadows Park District - Nelson Sports Complex sidewalk addition

