

Title	Greenslopes Park	12/08/2022
	by Tyler Quattrocchi in Member District ADA Project Request	id. 34322069
	410 N Arlington Heights rd Arlington Heights, Illinois 60004 IL United States 6306325992 tquattrocchi@AHPD.org	

Original Submission 12/08/2022

Name	Tyler Quattrocchi
Job Title	Park Planner
E-mail Address	tquattrocchi@gmail.com
Phone Number	6306325992
Park District	Arlington Heights
Project Location	Greenslopes Park
Project Status	Alteration
Project Type	Routes and Surfaces
Routes and Surfaces- select a Project Category below:	Accessible Routes- Means of Egress Ramps Sidewalks Walking Surfaces Athletic Surfaces
Benefits of the Project	Increased accessibility from parking lot to playing surfaces. Provided accessible route with slopes and grades not exceeding required maximums, wide enough gates to get onto tennis courts and pickle ball courts.
Items that will become ADA Compliant	Walking Path, Tennis Courts, Pickle-ball Courts

The project is designed or constructed, or applies human resources, to comply with:

**The 2010 Standards for Accessible Design
The Illinois Accessibility Code
Agency's ADA Transition Plan**

Upload Project Related Files, Photos, Videos or Audio

[DJI_0017.JPG](#)

[DJI_0018.JPG](#)

[Greenslopes_ADA_1.pdf](#)

[Greenslopes_ADA_2.pdf](#)

Budget Table for ADA Related Expenses

[Budget Table.xlsx](#)

ADA Dollars Requested	38560.0
-----------------------	----------------

Notes related to requested amount	Increased accessibility from parking lot to playing surfaces. Provided accessible route with slopes and grades not exceeding required maximums, wide enough gates to get onto tennis courts and pickle ball courts.
-----------------------------------	--



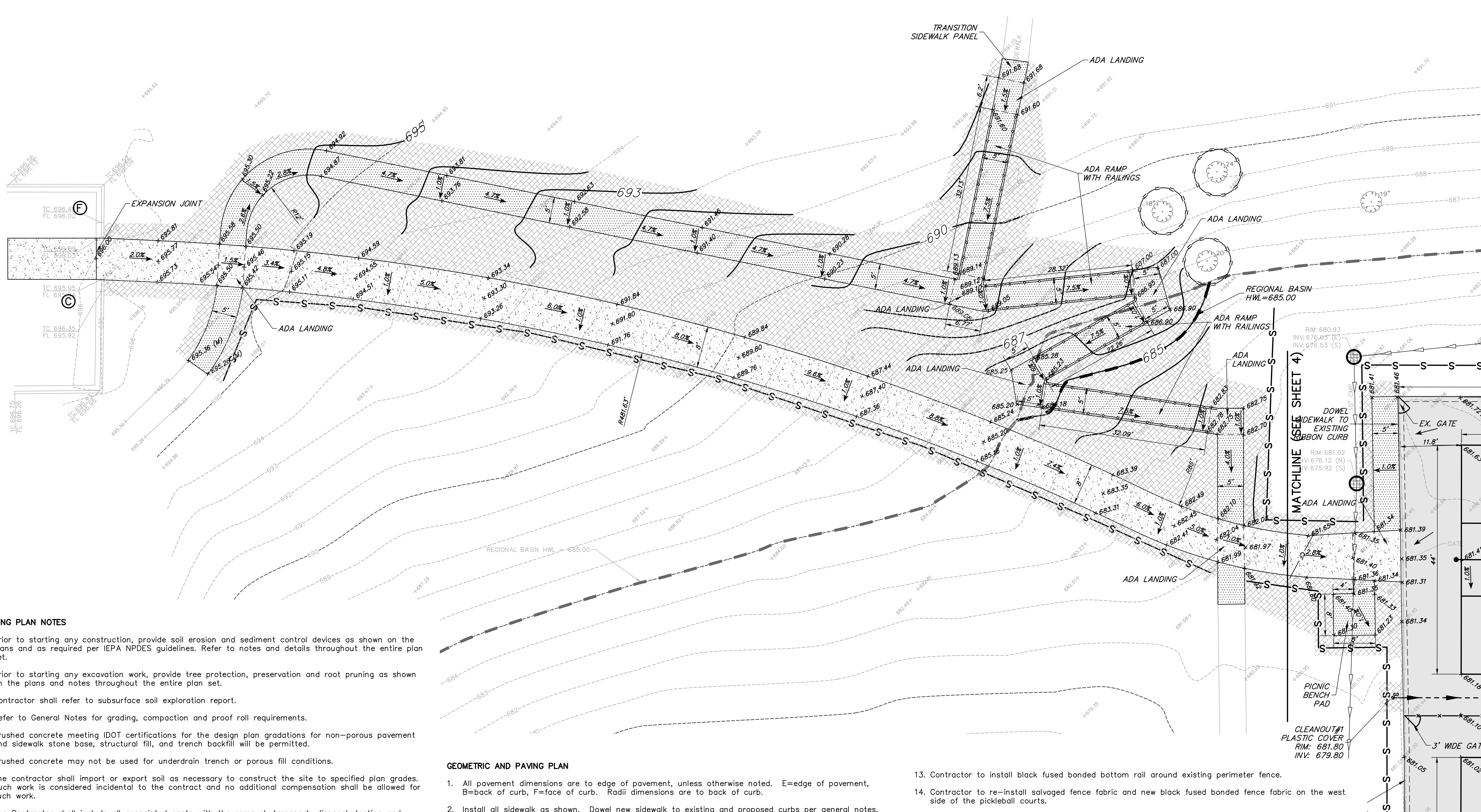
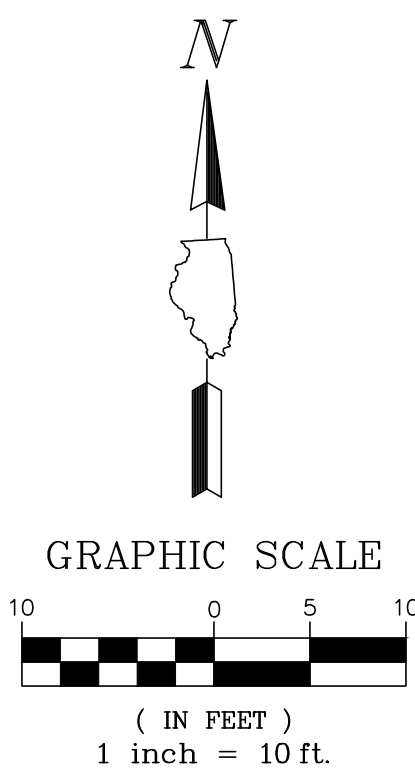

- LEGEND**
- TOP OF CURB FLOW LINE
 - PROPOSED SPOT ELEVATION
 - CONTOUR
 - GRADE BRAKE
 - SLOPES
 - SWALES
 - HMA COURT PAVEMENT (SEE DETAIL)
 - PCC PAVEMENT
 - PCC SIDEWALK
 - CURB W/ RAILING (SEE DETAIL)
 - FENCE
 - TREE TRUNK PROTECTION FENCE
 - PERIMETER EROSION BARRIER
 - REGIONAL BASIN HWL (685.00)

GRADING PLAN NOTES

1. Prior to starting any construction, provide soil erosion and sediment control devices as shown on the plans and as required per IEPA NPDES guidelines. Refer to notes and details throughout the entire plan set.
2. Prior to starting any excavation work, provide tree protection, preservation and root pruning as shown on the plans and notes throughout the entire plan set.
3. Contractor shall refer to subsurface soil exploration report.
4. Refer to General Notes for grading, compaction and proof roll requirements.
5. Crushed concrete meeting IDOT certifications for the design plan gradations for non-porous pavement and sidewalk stone base, structural fill, and trench backfill will be permitted.
6. Crushed concrete may not be used for underdrain trench or porous fill conditions.
7. The contractor shall import or export soil as necessary to construct the site to specified plan grades. Such work is considered incidental to the contract and no additional compensation shall be allowed for such work.
8. The Contractor shall include all associated costs with the removal, transport, disposal, testing and certification of "Uncontaminated Soil" as defined under 415 ILCS 5/3.160 including any fees, taxes, or surcharges charged by or through the operator(s) of Clean Construction or Demolition Debris Fill Operations or Uncontaminated Soil Fill Operations for the acceptance of Uncontaminated Soil.
9. All structures shall be adjusted to meet finished turf and pavement grades.
10. Refer to soil erosion and sediment control notes and details for seed and blanket requirements for temporary stabilization. Temporary seed is IDOT class 7.
11. Contractor shall provide the following as-constructed documents at the conclusion of the project:
 - a. Lawn or open space areas
 - Spot elevations and ridge / high and low points.
 - b. Tennis court and hard surfaces
 - Spot elevations at each court, net line, and fence line.
 - Spot elevations at summit / high and low points.
 - c. ADA sidewalk ramps, and ADA Routes
 - Provide 4 spot grades per square at landings and any tapers or ramps.
 - Provide spot elevations along route at maximum 10 foot spacing on both sides of the path to confirm cross and longitudinal slopes requirements have been met.
12. Provide makeup CA-6 stone, fine grading and recompaction of existing stone base. Compact existing base to 95% modified proctor density (ASTM D-1557). Prior to approval of the stone base, all pavement areas will be proof rolled. Any areas found to deflect shall be scarified and recompacted as directed by the engineer, until this standard is achieved.
13. Contractor shall ensure positive drainage to all inlets and catchbasins. Areas of surface ponding shall be corrected by the contractor at no additional expense to the Owner.
14. All lawn areas disturbed as a result of construction shall be restored to preconstruction lawn condition following restoration requirements.

GEOMETRIC AND PAVING PLAN

1. All pavement dimensions are to edge of pavement, unless otherwise noted. E=edge of pavement, B=back of curb, F=face of curb. Radii dimensions are to back of curb.
2. Install all sidewalk as shown. Dowel new sidewalk to existing and proposed curbs per general notes. When constructing a carriage walk, the proposed sidewalk contraction and expansion joints shall align with existing curb joints.
3. Provide 1.90% cross slope and 4.5% maximum longitudinal slope on all sidewalks and pedestrian path ways unless otherwise indicated. Illinois accessibility code requires a maximum constructed cross slope of 2.00% and longitudinal slope of 5.00%.
4. Install bituminous pavement as shown. Refer to detail sheet for specific pavement sections and general note sheet for construction, testing and compaction requirements.
5. Install PCC pavement as shown. Refer to detail sheet for specific pavement section and general notes for construction, testing and compaction requirements.
6. All 8" PCC pavement contraction joints shall be sawcut a minimum of 2" deep within 12 hours of pour.
7. Install 10' high chain-link fence & 3' wide access gates as shown. Refer to specifications and details. See sheet 2 for recommended construction sequence.
8. Install tennis and pickleball court posts, sleeves, and foundations. Install tennis and pickleball anchor straps and nets. Refer to specifications and details.
9. Install tennis and pickleball court pavement as shown.
10. HMA Paving - The Contractor shall string line the court pavement. Any areas that do not meet the minimum pavement cross slope (0.5%) will be corrected and re-compacted.
11. Tennis and pickleball courts shall be colored and striped per the details. Final line layout to be reviewed and approved prior to striping. Contractor shall notify Site Engineer 48 hours prior to installing court markings. Areas shall be masked off and 2 coats of color coat shall be applied. New white lines shall be provided. Refer to specifications for color coat requirements. Tennis and pickleball nets shall be provided and installed by the Contractor.
12. Re-hang all access gates. Provide minimum 1.5" clearance to finished grade.

13. Contractor to install black fused bonded bottom rail around existing perimeter fence.
14. Contractor to re-install salvaged fence fabric and new black fused bonded fence fabric on the west side of the pickleball courts.
15. Install 2 bang boards provided by Park District.
16. Contractor shall install temporary erosion control seed and blanket as necessary to meet soil erosion and sediment control requirements. Refer to notes and details throughout the plan set for specific material requirements. Temporary seed is IDOT class 7.
17. For final restoration, the contractor shall be responsible for restoring all disturbed turf areas and proposed turf areas as follows:
 - a. Prior to placement of topsoil restoration area subgrade material shall be rototilled and re-compacted to a maximum of 80% standard proctor to a depth of 6".
 - b. Spread a minimum of 6" of existing site salvaged screened topsoil or new pulverized topsoil on all disturbed areas. Compact to 80% standard proctor.
 - c. Topsoil must be free of litter, brush, rocks and earth clods of greater than 1 inch in any dimension. Contain between 1%-10% organic matter, 12%-50% clay, and less than 55% sand content. pH shall be between 6.0 and 8.0.
 - d. Seed restoration areas as follows:
 - IDOT Class 1 seed. (Lawn mixture)
 - Fertilizer shall be applied following IDOT requirements.
 - Erosion control blanket shall be North American Green S75 or approved equal installed following manufacturer guidelines.
 - e. Contractor shall be responsible for watering the restored area per IDOT specifications for a duration of 30 days prior to the Owner's final review and acceptance, at no additional cost to the Owner. If restoration has not shown a "catch" or uniform stand, the contractor shall repeat reseeded or resodded until a uniform stand is achieved.
15. Once restoration has been completed, the contractor shall remove erosion control devices. Silt fence trenches shall be backfilled and restored in kind. Storm structures shall be cleaned of debris.

NOTE: SEE SHEET 4 FOR UTILITY PLAN NOTES

SESC LEGEND

- TOPSOIL FURNISH AND PLACE, VARIABLE DEPTH, 6" MIN. SEEDING, CLASS 7 (TEMPORARY)
- EROSION CONTROL BLANKET NAG S150 (3:1 SLOPES OR STEEPER)
- STORM SEWER INLET PROTECTION: - INLET FILTER BASKET & COIR LOG
- PORTABLE RESTROOM FACILITY
- CONCRETE WASHOUT

G:\AS\DRAWING\1400\GREEN SLOPES PARK SITE IMPROVEMENTS\14115 - SEEDING - 12/7/2020 1:17 PM

GHA GEWALT HAMILTON ASSOCIATES, INC.
 625 Forest Edge Drive ■ Vernon Hills, IL 60061
 TEL 847.478.9700 ■ FAX 847.478.9701

COPYRIGHT NOTICE
 This drawing is the property of Gewalt-Hamilton Assoc., Inc. and is not to be used for any purpose other than the specific project and site named herein, and cannot be reproduced in any manner without the express written permission from Gewalt-Hamilton Associates, Inc.

PROPOSED IMPROVEMENTS - WEST
GREEN SLOPES PARK SITE IMPROVEMENTS
ARLINGTON HEIGHTS PARK DISTRICT
VILLAGE OF ARLINGTON HEIGHTS, ILLINOIS 60005

NO.	BY	DATE	REVISION

FILE: 5313.115 - PR1.dwg	SHEET NUMBER:
DRAWN BY: LLM	GHA PROJECT #
DATE: 12-07-20	5313.115
CHECKED BY: WEG	SCALE:
DATE: 12-07-20	1"=10'
	OF 8 SHEETS

3

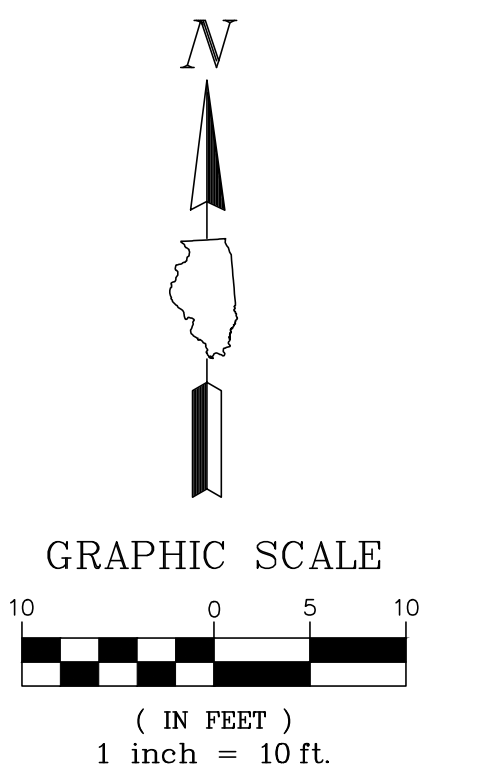
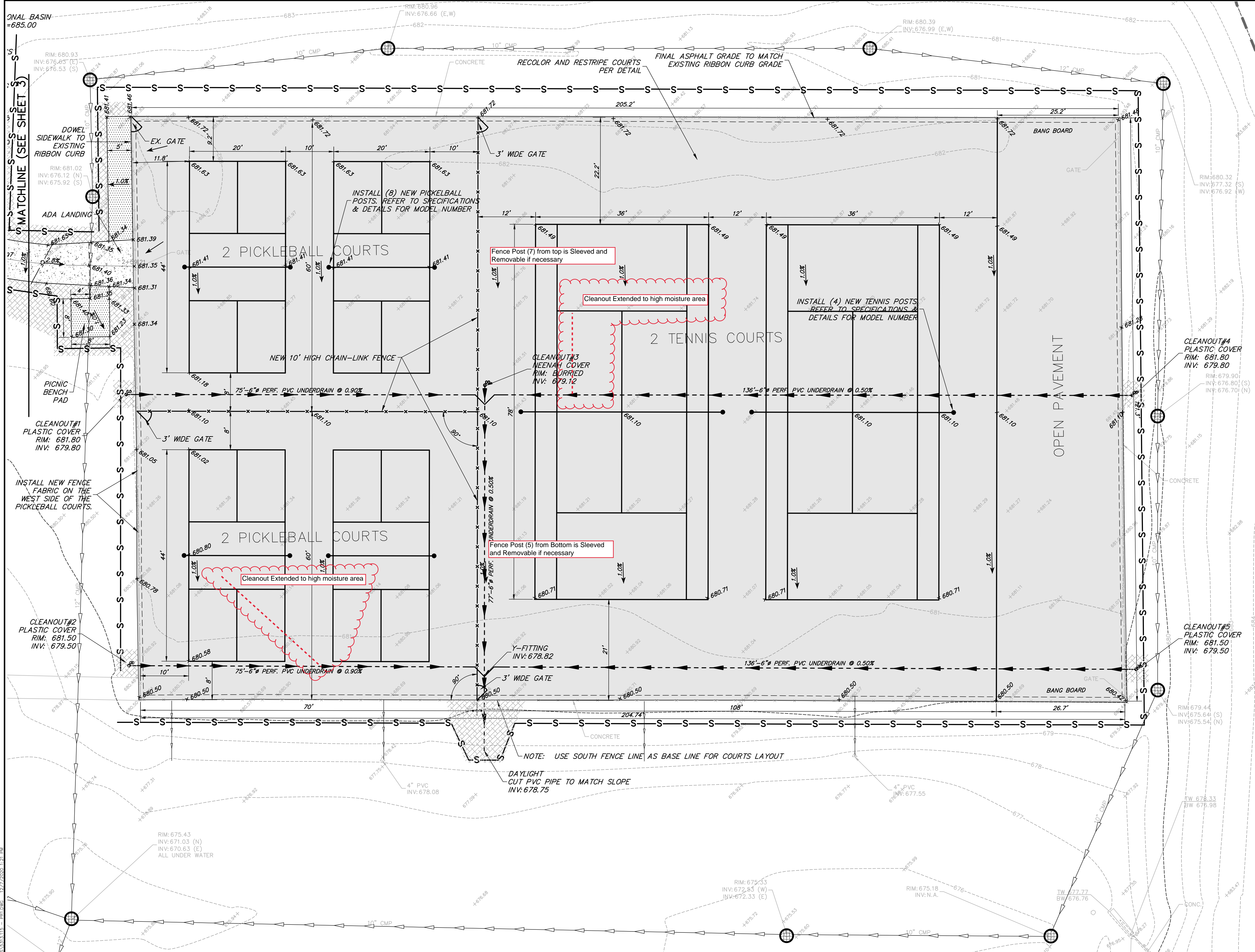

UTILITY PLAN NOTES

- The contractor shall verify the exact location and elevation of existing utilities prior to initiating work. Any discrepancies found between the information noted on the plans and actual field conditions, or any conflicts with proposed improvements shall be reported to the engineer immediately. The contractor shall not proceed any further until given written clarification on how to proceed.
- Install storm sewer as shown. Refer to Storm Sewer requirement table on General Notes Sheet for pipe material, joint, frame and grate, stone bedding and testing requirements.
- Contractor shall provide the following as-constructed documents at the conclusion of the project:
 - Storm Sewer
 - As-constructed locations of structures, service connections, cleanouts.
 - Rim and invert elevations.
 - Color video with transcript required for new sewer lines installed.
- The Contractor shall include all associated costs with the removal, transport, disposal, testing and certification of "Uncontaminated Soil" as defined under 415 ILCS 5/3.160 including any fees, taxes, or surcharges charged by or through the operator(s) of Local Construction or Demolition Debris Fill Operations or Uncontaminated Soil Fill Operations for the acceptance of Uncontaminated Soil.
- Drainage cleanout rims shall be flush with adjacent finished grades.

LEGEND

- TOP OF CURB FLOW LINE
- PROPOSED SPOT ELEVATION
- CONTOUR
- GRADE BRAKE
- SLOPES
- SWALES
- HMA COURT PAVEMENT (SEE DETAIL)
- PCC PAVEMENT
- PCC SIDEWALK
- CURB W/ RAILING (SEE DETAIL)
- FENCE
- TREE TRUNK PROTECTION FENCE
- PERIMETER EROSION BARRIER
- REGIONAL BASIN HWL (685.00)

SESC LEGEND

- TOPSOIL FURNISH AND PLACE, VARIABLE DEPTH, 6" MIN. SEEDING, CLASS 7 (TEMPORARY)
- EROSION CONTROL BLANKET NAG S150 (3:1 SLOPES OR STEEPER)
- STORM SEWER INLET PROTECTION: - INLET FILTER BASKET & COIR LOG
- PORTABLE RESTROOM FACILITY
- CONCRETE WASHOUT

NOTE: SEE SHEET 3 FOR GRADING & PAVING PLAN NOTES

GHA GEWALT HAMILTON ASSOCIATES, INC.
 625 Forest Edge Drive ■ Vernon Hills, IL. 60061
 TEL 847.478.9700 ■ FAX 847.478.9701

COPYRIGHT NOTICE
 This drawing is the property of Gewalt-Hamilton Assoc., Inc. and is not to be used for any purpose other than the specific project and site named herein, and cannot be reproduced in any manner without the express written permission from Gewalt-Hamilton Associates, Inc.

PROPOSED IMPROVEMENTS - EAST
GREEN SLOPES PARK SITE IMPROVEMENTS
ARLINGTON HEIGHTS PARK DISTRICT
VILLAGE OF ARLINGTON HEIGHTS, ILLINOIS 60005

NO.	BY	DATE	REVISION

FILE: 5313.115 - PR1.dwg	SHEET NUMBER:
DRAWN BY: LLM	GHA PROJECT #
DATE: 12-07-20	5313.115
CHECKED BY: WEG	SCALE:
DATE: 12-07-20	1"=10'
	OF 8 SHEETS

4

Project Type (From Above)	Project Category (From Above)	Media File #/Name	Project Category Cost	ADA Portion of Project Category Cost	% ADA Dollars Requested
Routes and Surfaces	Accessible Routes, Athletic Surfaces, Ramps, and	DJI_0017 thru 18, Greens	483000	38560	7.98%

#VALUE!
#VALUE!
#DIV/0!
#DIV/0!
#DIV/0!
#DIV/0!
#DIV/0!
#DIV/0!
#DIV/0!
#DIV/0!
#DIV/0!
#DIV/0!
#DIV/0!
#DIV/0!
#DIV/0!
#DIV/0!
#DIV/0!
#DIV/0!
#DIV/0!
#DIV/0!

Total Project Cost	483000
Total ADA Portion of Project Cost	38560
Total % of ADA Dollars Requested	7.98%